

centre Madison Ave.

23rd br Mad. & Monroe.

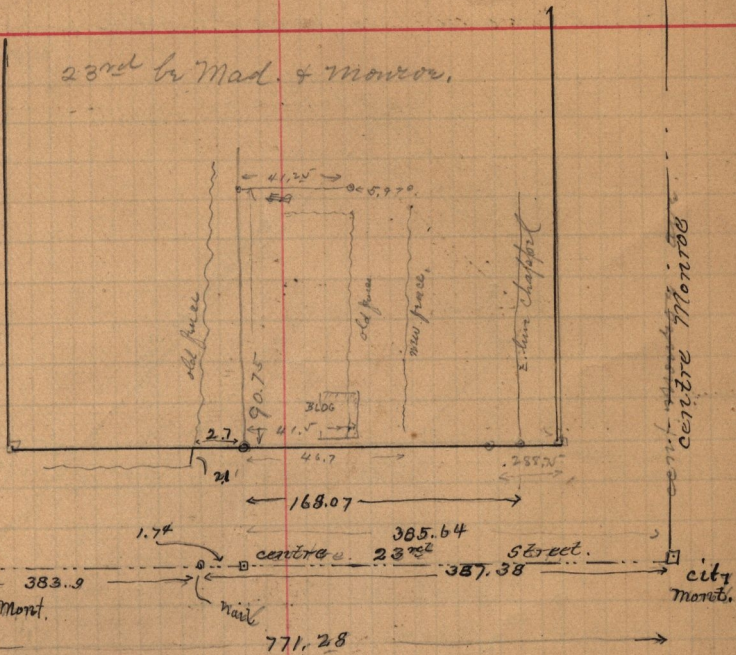

centre Monroe

Wm. Chappel - W. 1/2 Lot 1-B-11 - Plat B -
 E. J. White head to Orion River - Beg. 7 rods E. of S.W. cor
 of said Lot, 1-B-11, thence E. 3 rods, N. 8 rods W 3.
 S 9 rods to beg.
 Julia S. Chappel to Orion River. Pt W 1/2 of Lot 1-B-11 - Plat
 B - Beg. 3 rods from S.E. cor of said Lot thence W. 1 rod
 N 8 rods E & S to beg.

See also Book
 "J." field notes
 page 131.